

Samuel Thomson

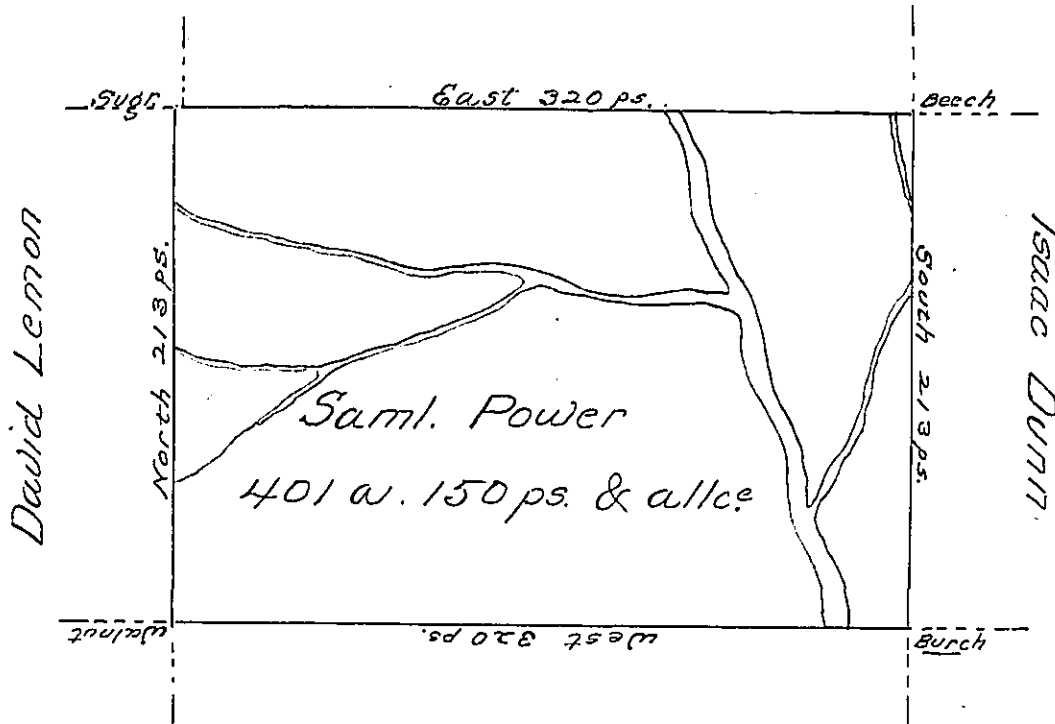

Thomas Dunn

Situate on the west side of French Creek in Allegheny County containing 401 acres and 150 ps. and allowance of Six per cent for Roads &c. Surveyed the 5th day of November 1794. In pursuance of his Improvement bearing date the 4th day of November 1794

Wm. Power Dyk.
 To Daniel Brodhead Esq.
 Surveyor General

IN TESTIMONY that the above is a copy of the original remaining on file in the Department of Internal Affairs of Pennsylvania, made conformably to an Act of Assembly approved the 16th day of February, 1833, I have hereunto set my Hand and caused the Seal of said Department to be affixed at Harrisburg, this seventh day of July 1903

Loac B Brown
 Secretary of Internal Affairs.